

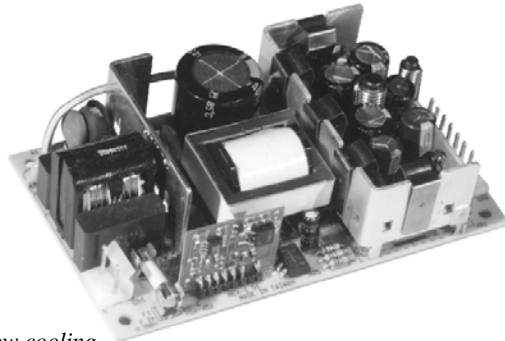

60W* Universal Class B EMI Series PSA45 Series One to Four Output 3x5 Power Supplies



*60W Rated at 20CFM air flow cooling

Features

- Industrial
- Zero Minimum Loads
- Surface Mount Controller
- ISA 9001 Quality System
- Extended Design Life

Applications

- Networking
- Peripherals and Terminals
- Mini-microcomputers

Safety Approvals

- UL/CUL 60950-1

Mechanical Characteristics

- Length: 127mm (5in)
- Width: 76.2mm (3in)
- Height: 30.0mm (1.2in)
- Weight: 270g (9.5oz)

Output Specifications

Model	DC Output Voltage	Load				Ripple P-P ⁽¹⁾	Total ⁽²⁾ Regulation
		Min.	Convection	20cfm	Peak ⁽³⁾		
PSA45-033 ⁽⁴⁾	+3.3V	0A	9A	10A	10A	50mV	±2%
PSA45-050 ⁽⁴⁾	+5V	0A	8A	10A	10A	50mV	±2%
PSA45-120 ⁽⁴⁾	+12V	0A	4A	5A	5A	120mV	±2%
PSA45-150 ⁽⁴⁾	+15V	0A	3A	4A	4A	150mV	±2%
PSA45-240 ⁽⁴⁾	+24V	0A	2A	2.5A	2.5A	240mV	±2%
PSA4531	+5V(V1)	0A	4A	5A	7A	50mV	±2%
	+12V(V2)	0A	1.5A	2.5A	4A	120mV	±5%
	-12V(V3)	0A	0.5A	0.5A	1A	120mV	±5%
PSA4534	+5V(V1)	0A	4A	5A	7A	50mV	±2%
	+15V(V2)	0A	1.2A	2A	3A	150mV	±5%
	-15V(V3)	0A	0.5A	0.5A	1A	150mV	±5%
PSA4541	+5V(V1)	0A	3A	5A	7A	50mV	±2%
	+12V(V2)	0A	2A	2A	4A	120mV	±5%
	-12V(V3)	0A	0.5A	0.5A	1A	120mV	±5%
	-5V(V4)	0A	0.5A	0.5A	1A	50mV	±5%

(1) Measured at 45W by using a 12-inch twisted pair, terminated with a 10mfd capacitor and 0.1mfd ceramic in parallel.

(2) See Reverse for exact tolerances; may deviate during peak loading conditions

(3) Peak output of less than 30 Seconds; total peak power not to exceed 60W.

(4) Special order model. Minimum order quantity of 1500 pieces required

Phihong is not responsible for any error, and reserves the right to make changes without notice. Please visit our website at www.phihong.com for the most up-to-date specifications and contact information.

Input:

AC Input Voltage Rating

100 to 240V AC

AC Input Voltage Range

90 to 264V AC

AC Input Frequency

47 to 63Hz

Input Current

2A (RMS) at maximum load and 120V AC

1A (RMS) at maximum load and 240V AC

Leakage Current

3.5mA maximum

Inrush Current

30A for 120V AC at maximum load

60A for 240V AC at maximum load

(Cold start at ambient 25°C)

Hold-up Time

12mX typical at maximum load at 120V AC, 60Hz

Output:

Efficiency

68% typical at maximum load and 120V AC

Over-Voltage Protection

Crowbar, V1 only

Over-Current Protection

Short-Circuit Protection – Auto-Restart

Environmental:

Temperature

Operation 0 to 50°C

Non-operation -25 to +85°C

Humidity

Operation 5 to 95% non-condensing

Emissions

FCC Class B

EN55022 Class B

General:

Insulation Resistance

50M ohm minimum

Dielectric Withstand (Hi-pot) Test

Input to Ground: 1500V AC for 1 minute, 10mA

Switching Frequency

50KHz typical

MTBF (Full load and 110V AC, 25°C)

100K hours at maximum load

AC Mating Connector

Molex 09-50-3031

DC Output Connector

Molex: 09-50-3061 or 3081(Quad only)

Dimension Diagram Unit: mm (inch)

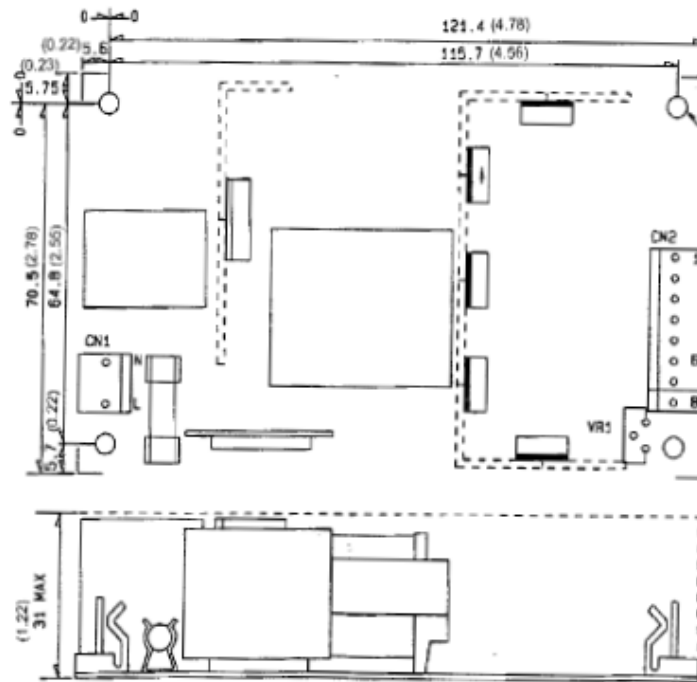

For Single Output:

CN1	1	L
	2	N
CN2	1	+V
	2	+V
	3	+V
	4	GND
	5	GND
	6	GND

For Multiple Outputs:

CN1	1	L
	2	N
CN2	1	V ₂
	2	V ₁
	3	V ₁
	4	GND
	5	GND
	6	V ₃
	7	V ₄ GND
	8	V ₄