



**75W IEEE802.3bt Power over Ethernet
Single Port Injector.
IP67 Rated for Outdoor Applications**



Features

- Compliant with the IEEE802.3bt Standard
- Gigabit Compatible
- IP67 Rating(waterproof)
- -40°C to +65°C Temperature Range
- Up to 90W with Derated Temperature
- Non-Vented Case with Mounting Bracket
- Full Protection OCP, OVP
- 1-Year Warranty
- Cable Glands and AC connector included for Waterproof Operation

Applications

- Outdoor Security Cameras
- Outdoor Wireless Access Points
- Outdoor Emergency Lighting

Safety Approvals

- cUL/UL
- CE

Mechanical Characteristics (with Mounting Bracket)

- Length: 246mm (9.69in)
- Width: 170mm (6.69in)
- Height: 58.5mm (2.30)
- Weight: 2.2kg

Output Specifications

Model	Data Speed	DC Output Voltage	Load		Ripple ¹ P-P (max.)	Regulation Line & Load
			Min.	Max.		
POEO75U-1BT-R	2.5G	56V	≤10mA	1.6A	200mV	+1/-2V
POEO75U-1BT-X-R	10G	56V	≤10mA	1.6A	200mV	+1/-2V

Notes:

1. Measured with by-pass capacitors 0.1uf/10uf at output connector terminal and oscilloscope set at 20Mhz (tested by oscilloscope). 20 minutes warm-up required when operating at negative temperature

INPUT:

AC Input Voltage Range
90 to 264VAC

AC Input Voltage Rating
100 to 240VAC

AC Input Current
2.5A (RMS) and 90VAC at maximum load
1.2A (RMS) and 240VAC at maximum load

AC Input Frequency
47 to 63Hz

Leakage Current
3.5mA max @254VAC, 50Hz

Max Inrush Current
50A for 115VAC at maximum load
75A for 240VAC at maximum load

OUTPUT:

Total Output Power
75W at 65°C
90W at 50°C

Efficiency²
85% (typical) at full load, 120VAC 60Hz

ENVIRONMENTAL:

Temperature

Operation	-40 to +65°C
Non-operation	-40 to +65°C
Humidity	5 to 90%

EMI

Complies with FCC Class B
Complies with EN55032 Class B

HI-POT Test

Primary to Secondary: 4242 VDC for 1 minute, 10mA
Primary to Field Ground: 2121VDC for 1 minute, 10mA
Output to Field Ground: 2121VDC for 1 minute, 10mA

Immunity

ESD: IEC61000-4-2 Level 3
RS: IEC61000-4-3 Level 3
EFT: IEC61000-4-4 Level 2
Surge: IEC61000-4-5 6KV
CS: IEC61000-4-6 Level 3
Voltage Dips IEC61000-4-11
Harmonic: EN61000-3-2 Class A

Insulation Resistance

Primary to Secondary: >10M OHM
500VDC
Primary to Earth Ground: >10M OHM
500VDC

FEATURES:

Over Voltage Protection:
Conforms to UL60950-1

Over-Current Protection:
≤2000mA max

Short Circuit Protection

Non-latching auto recovery, output can be shorted permanently without damage.

Input Connector

Twist lock 3 pin provided

Output PoE Connector

RJ45 with cable glands

Output PoE Connection

+pins 3, 4, 5, 6 / -pins 1, 2, 7, 8

Notes:

1. The characteristics defined are at ambient temperature of 25°C unless otherwise specified
2. Efficiency is measured after 30 minutes burn-in

Input/Output Case Ports

Data only - RJ45 + cable gland
Data + Power – RJ45 + cable gland
AC input – Exceedcon EP030-2224-00 EP series

Network Switch

Network Switch should be Environment Rated B as per paragraph 33.4.1.1 of the IEEE802.3at standard.

Dimension Diagram unit: mm

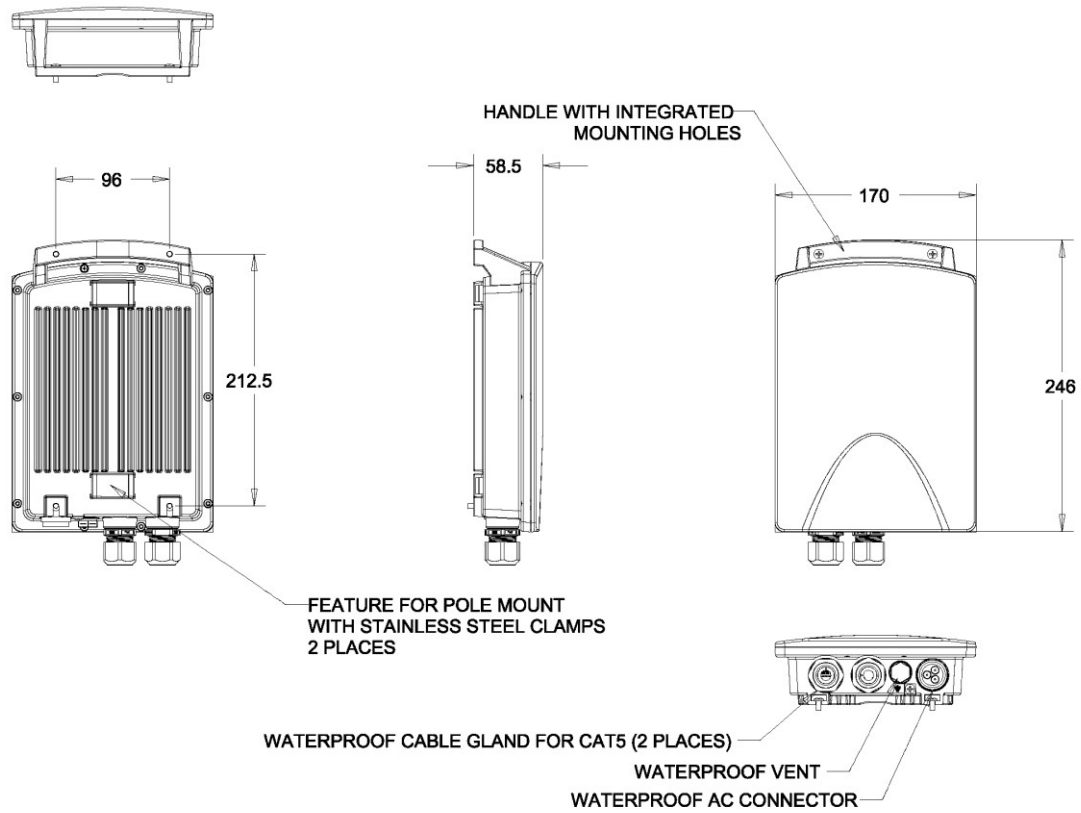

Single Cable Gland – similar to below. * Dimension Diagram unit:mm

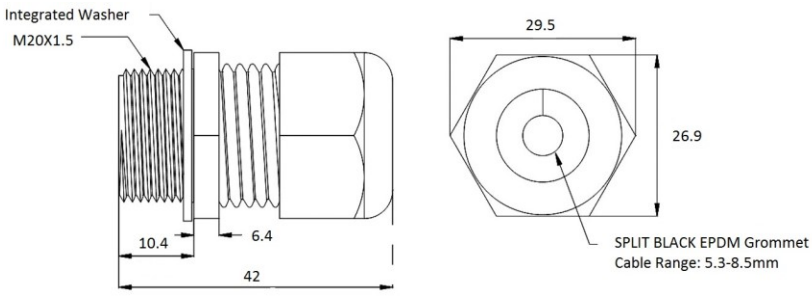

Note *: Cable Glands are included